

Low Head Socket Cap Screw

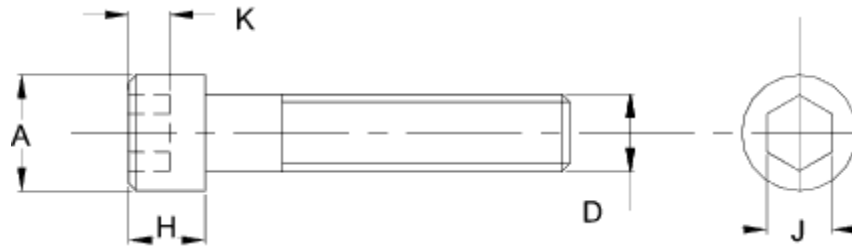

Socket Head Cap Screw

Plain = SC800-----

Zinc = SC800-----ZB

Class 3A Fit Rockwell Hardness 38-43

Nominal Size, Inches	D		A		H		J
	Body Diameter		Head Diameter		Head Height		Socket Size
	Max	Min	Max	Min	Max	Min	
#8	.164	.1585	.270	.262	.082	.079	.141
#10	.190	.184	.312	.303	.095	.092	.156
.250	.250	.2435	.375	.365	.125	.121	.188
.3125	.3125	.3053	.469	.457	.156	.152	.250
.375	.375	.3678	.562	.550	.187	.182	.312
.4375	.4375	.4294	.656	.642	.218	.213	.375
.500	.500	.4919	.750	.735	.250	.244	.375